



Impeller
(3.1") 80 mm

Macerator Pump 01 Series

Features & Benefits

- Dual Blade and Housing
- Seamless Shell Design
- Thermally Protected Motor
- High Quality Efficient Motor
- Run Dry Capability

Typical Applications

- RV & Campers
- Boats & Mobile Kitchenware
- Industrial
- Marine

PUMP

Liquid Temperature
140°F (60°C) Max.

Priming Capabilities
Not needed flooded suction

Power
12 amps max current draw

Max Pressure
Not needed

Inlet/Outlet Ports
Inlet: 1.5" (39 mm) Hose Barb
or thread fitting
Outlet: 1" Hose Barb

Weight
4.9 lbs (2.24 kg)

MOTOR

Type
High quality seamless design
that is thermally protected

Leads
Wire leads

Temperature Limits
140°F (60°C) Max.

Duty Cycle
Intermittent

Voltage
12v/24v

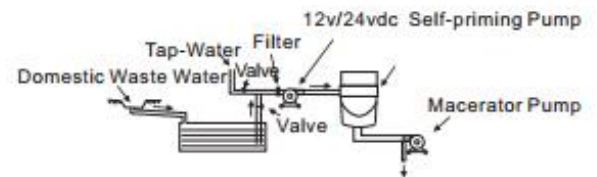
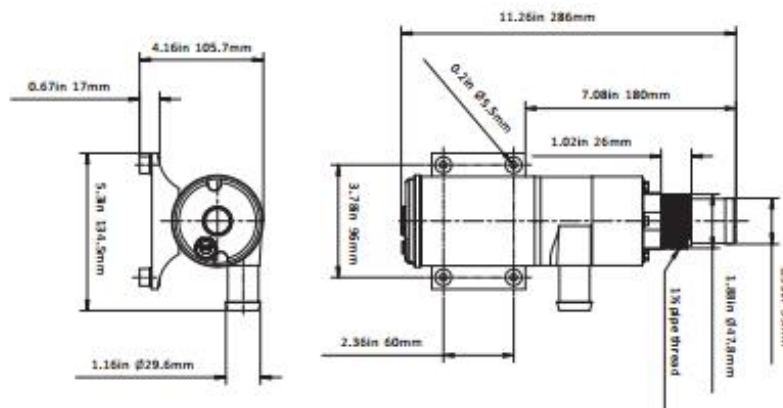

Typical application

STANDARD PUMP CONFIGURATIONS

Model	GPM/LPM	Dimensions	Impeller	Ports	Lead	Molded	Voltage	Max Draw(A)
SFMP1-120-01	12/45.0	13.98"x5.24"x4.33" 355x133x110mm	Rubber & copper	1.5"Hose Barb 1"Hose Barb	Yes	N/A	12v	12.0
SFMP2-120-01	12/45.0	13.98"x5.24"x4.33" 355x133x110mm	Rubber & copper	1.5"Hose Barb 1"Hose Barb	Yes	N/A	24v	7.0